

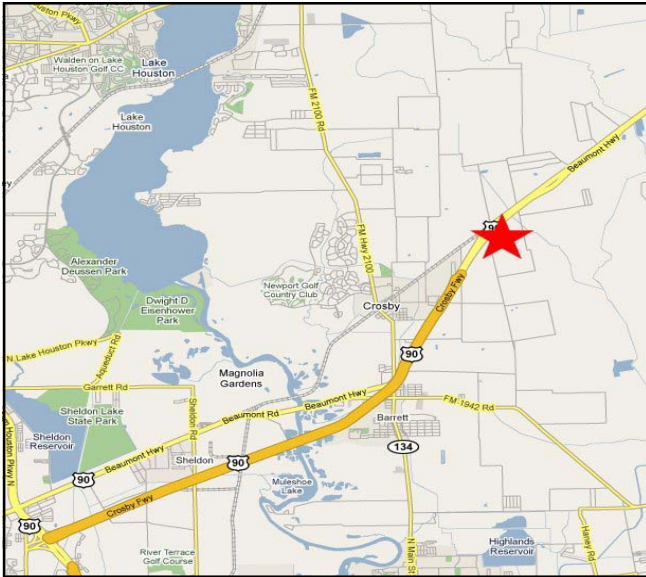

# Al Lum Properties



## Beaumont Highway (US 90) Crosby, Texas

4.187 acres—F.A. Whitaker Survey, between Bohemian Hall Rd and Janacek Rd. Excellent location with great visibility and lots of frontage.

Not in flood Plain, No utilities, 382.5' +/- frontage

Approx: 382' X 841' X 277' X 547'

Km page 380X 2008 tax rate \$2.05

Asking Price: \$215,000

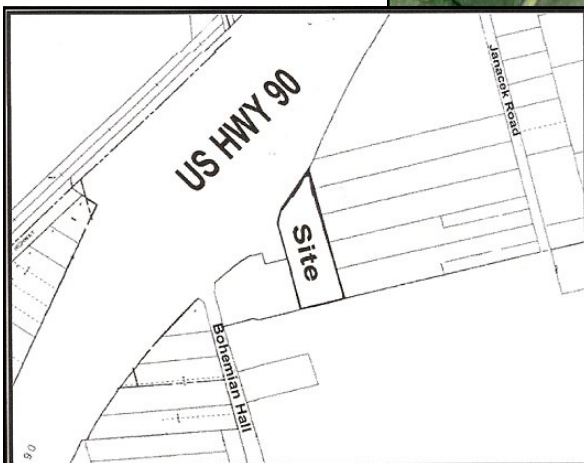

**Contact Rebecca Lum  
281-821-2020**

Al Lum Properties, Inc.  
7941 Katy Fwy #331 Houston, Texas 77024  
281.821.2020 Fax:281.821.0100  
[www.allumproperties.com](http://www.allumproperties.com)

The information above is believed to be true and reliable, but no warranty or representation, express or implied, is made as to its accuracy. This information is submitted subject to errors, omissions, change of price, rental or other conditions, withdrawal without notice, and to any listing conditions imposed by our principles.